

JANUARY 2009 BLOCK OF THE MONTH

Campbell House

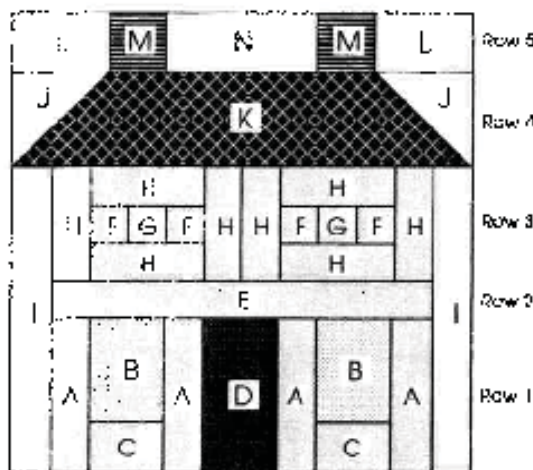

Row 5

Row 4

Row 3

Row 2

Row 1

Block Size:
12" (or 6") finished

Seam Allowance:
 $\frac{1}{4}$ "

**Full Size
Quilt Guide:**
Page 61

Photo on Page 36

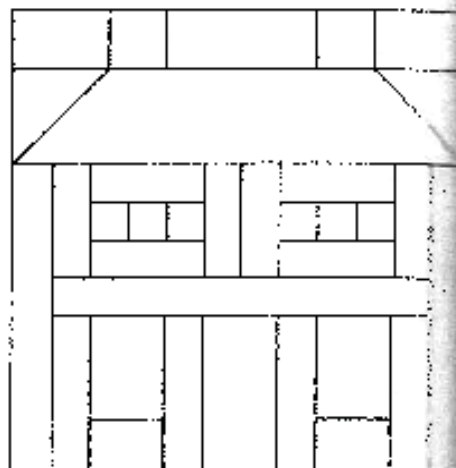

A, B, C, D, E, H, I, L, N - Rectangle

F, G, M - Square

J - Half Square Triangle

K - Full Trapezoid

Numbers in parentheses are for the 6" block.

A - Cut 4 - $1\frac{1}{2}$ " x $4\frac{1}{2}$ " rectangles, medium dark.
(1 " x $2\frac{1}{2}$ ")

B - Cut 2 - $2\frac{1}{2}$ " x $3\frac{3}{4}$ " rectangles, medium light.
($1\frac{1}{2}$ " x $1\frac{3}{4}$ ")

C - Cut 2 - $1\frac{3}{4}$ " x $2\frac{1}{2}$ " rectangles, medium dark.
($1\frac{1}{4}$ " x $1\frac{1}{2}$ ")

D - Cut 1 - $2\frac{1}{2}$ " x $4\frac{1}{2}$ " rectangle, dark.
($1\frac{1}{4}$ " x $2\frac{1}{2}$ ")

E - Cut 1 - $1\frac{3}{4}$ " x $10\frac{1}{2}$ " rectangle, medium dark
(1 " x $5\frac{1}{2}$ ")

F - Cut 4 - $1\frac{1}{2}$ " squares, medium light. (1 ")

G - Cut 2 - $1\frac{1}{2}$ " squares, medium dark. (1 ")

H - Cut 8 - $1\frac{1}{2}$ " x $3\frac{1}{2}$ " rectangles, medium dark.
(1 " x 2 ")

I - Cut 2 - $1\frac{1}{2}$ " x $8\frac{1}{2}$ " rectangles, light.
(1 " x $4\frac{1}{2}$ ")

J - Cut 1 - $3\frac{3}{8}$ " square, light. ($2\frac{1}{8}$ ")
Cut in half diagonally, once.

K - Cut 1 - 3 " x $13\frac{1}{4}$ " rectangle, contrasting dark, ($1\frac{3}{4}$ " x $7\frac{1}{4}$ ") To recut into a full trapezoid, use a 5 " square Omnigrid® ruler. Place the ruler so the 45° line is in the corner of the rectangle. Also keep the 45° line on the bottom of the rectangle. Cut off the excess fabric. Slide the ruler to the other corner of the rectangle and cut off the excess fabric.



L - Cut 2 - 2 " x 3 " rectangles, light. ($1\frac{1}{4}$ " x $1\frac{3}{4}$ ")

M - Cut 2 - 2 " squares, contrasting medium dark.
($1\frac{1}{4}$ ")

N - Cut 1 - 2 " x $4\frac{1}{2}$ " rectangle, light. ($1\frac{1}{4}$ " x $2\frac{1}{2}$ ")

pressing directions
and show pressing direction.

ROW 1:

1. Sew **B** to **C**. Press. Make two sets.



2. Sew one **A** to each side of the **B/C** set. Press. Make two sets.

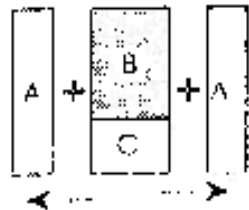

3. Sew one of the **A/B/C** sets to each side of **D**. Press.

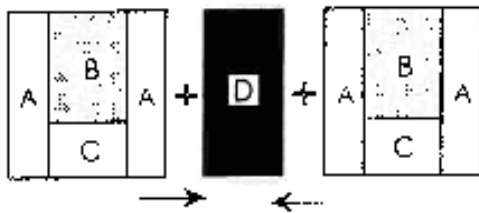

4. Sew **Row 1** to **E (Row 2)**. Press to **Row 2, (E)**.

ROW 3:

5. Sew one **F** to each side of **G**. Press. Make two sets.



6. Sew one **H** to the top and bottom of the **F/G** set. Press. Make two sets.

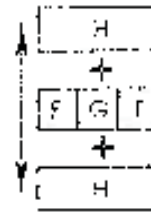

7. Sew and press according to the diagram.

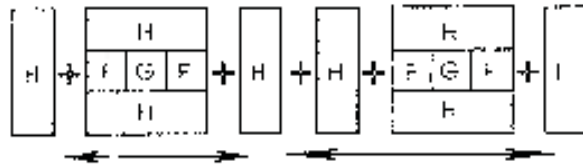

8. Sew **Row 3** to **(Row 2) E**. Press to **Row 2 (E)**.

9. Sew **I** to each side of the sewn **Row 1, 2 and 3** unit. Press to **I**.

ROW 4:

10. Sew one **J** to each side of **K**. Press. Cut off the dog ears.



11. Sew **Row 4** to **Row 3**. Press to **Row 4**.

ROW 5:

12. Sew and press according to the diagram.

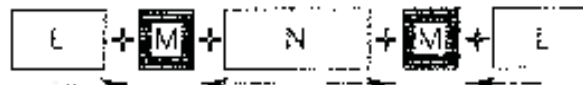

13. Sew **Row 5** to **Row 4**. Press to **Row 5**.

The Campbell House pattern is named after my friend, Bonnie Campbell, from Fairfax, VA.